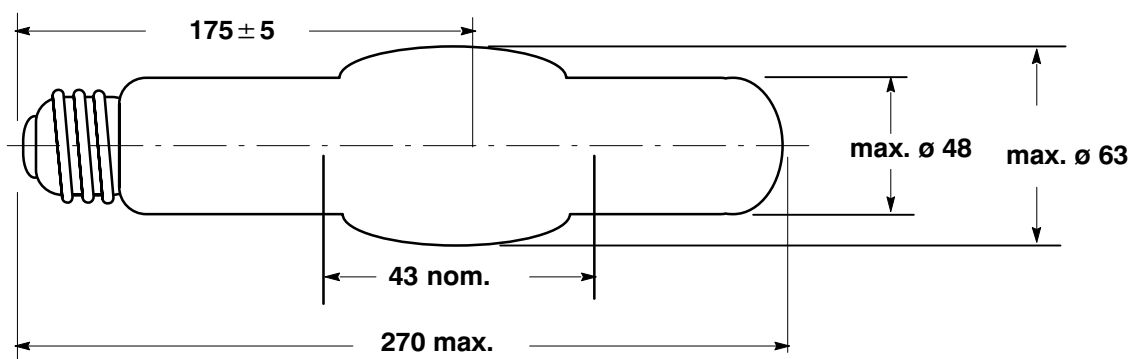

**DIMENSIONS (mm)**

Cap : E40/45 (IEC 61-1)

Bulb : hard glass

on HSL gear**on SHP gear****ELECTRICAL DATA:**

		Nom.	Min.	Max.	Nom.	Min.	Max.
Lamp wattage	(W) :	400			440		
Lamp voltage	(V) :	130	115	145	130	115	145
Lamp current	(A) :	3.4			4.4		
Lamp warm-up current	(A) :		3.4	5.8		4.4	7.5
Frequency	(Hz) :	50			50		

OPERATING CONDITIONS:

		Nom.	Min.	Max.	Nom.	Min.	Max.
Burning position	:	p20					
Fixture type	:	closed					
Ballast type	:	HSL400W/SHP400W (220V, 230V, 240V, 250V)					
Voltage current ratio	(W) :	45			39		
Calibration current	(A) :	3.25			4.6		
Supply voltage	(%) :		90	106			
Ignitor pulse	(kVp) :	Min. 560 (pulse width > 260 ms)					
Compensation capacitor	(mF) :	28			45		
Cap rim temperature	(°C) :			250			
Bulb temperature	(°C) :			400			

LAMP LIFE :

Rated Average Life	(h) :	20000 (50% survival rate)
T 90	(h) :	10000 (90% survival rate)
Economical Life	:	11 000

ATTENTION : Lamps comply with the safety requirements of IEC publication 60188. Ballasts and luminaires must comply with IEC 60923 and 60598-1, respectively. Inspection is in accordance with IEC 60410. Due to high operating pressure inside the lamp, the possibility exists that in extreme circumstances the lamp might shatter. Lamps should not be operated with a broken or absent outer envelope.

Issued by : TIENEN
Date : 08.01.1997
Revision date : 12.10.2009

DATA SHEET

Specification No. : 43 09 400/I
Supersedes : 4309400/H 17.03.2009
Page 1 of 2

**PHOTOMETRIC DATA :** (1), (2)

		<u>on HSL gear</u>	<u>on SHP gear</u>
Initial luminous flux	(lm) :	36000	40000
Luminous efficacy	(lm/W) :	90	90
Mean Luminous flux (3)	(lm) :	27000	30000
Correlated colour temperature	(K) :	4200	4200
Colour rendering index	(class) :	2B	2B

- (1) Measurements are done at nominal supply and after 100 h of ageing.
(2) Photometric data is valid for situations where the arc tube tips does not face downwards
(3) Mean Luminous flux is defined as the average luminous flux over the economical life

ATTENTION : Lamps comply with the safety requirements of IEC publication 60188. Ballasts and luminaires must comply with IEC 60923 and 60598-1, respectively.
Inspection is in accordance with IEC 60410. Due to high operating pressure inside the lamp, the possibility exists that in extreme circumstances the lamp might shatter.
Lamps should not be operated with a broken or absent outer envelope.

Issued by : TIENEN
Date : 08.01.1997
Revision date : 12.10.2009

DATA SHEET

Specification No. : 43 09 400/I
Supersedes : 4309400/H 17.03.2009
Page 2 of 2